

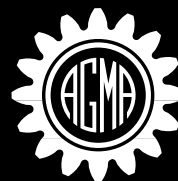

OMNI GEAR®

TRACTOR POWERED
IMPLEMENT GEARDRIVES

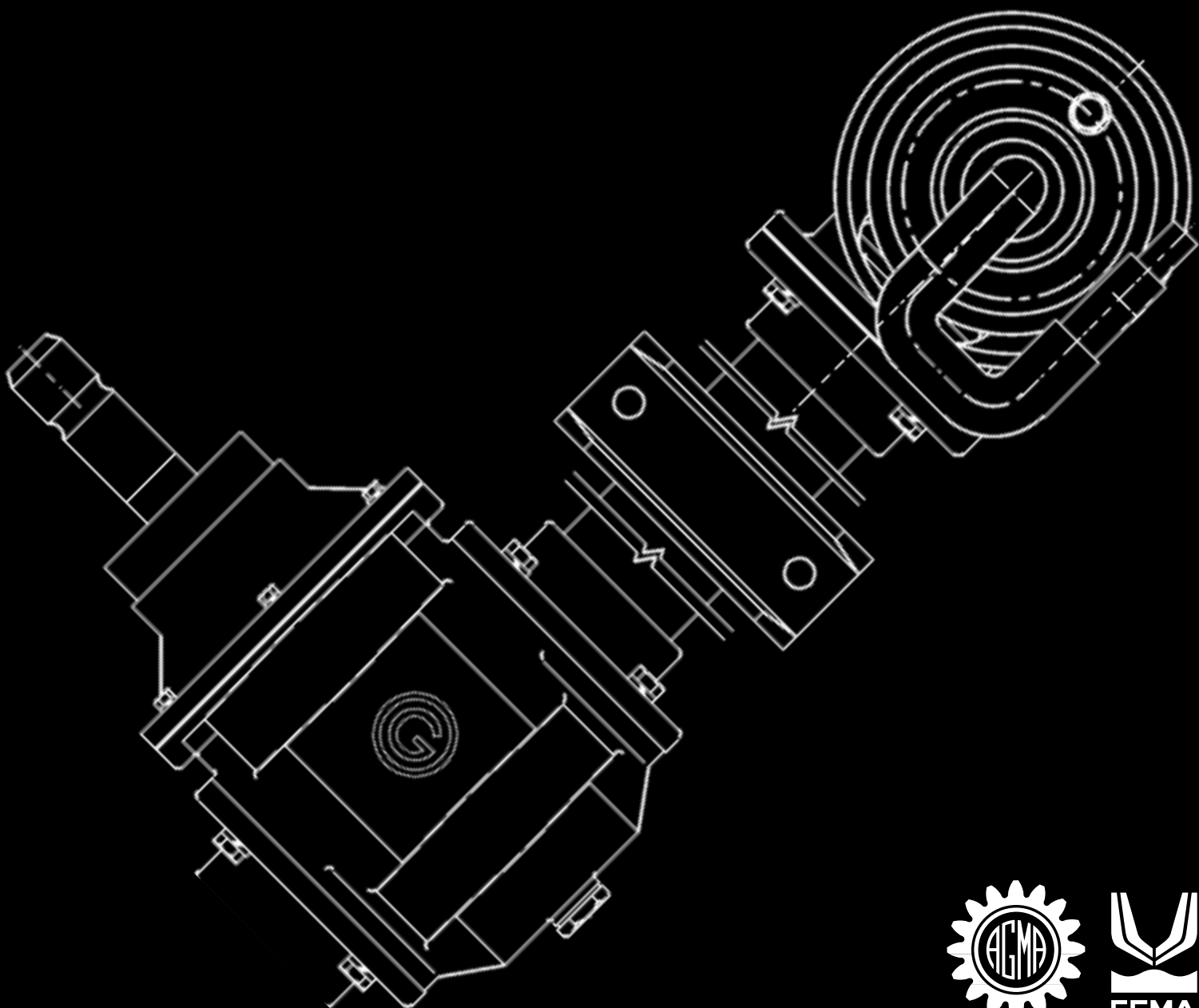

PHD-15 Series

Power: 15 hp
11 kW

Post Hole Digger Drives

Specifications

Torque: 1750 lb.-in.
198 Nm.
Ratios: 3:1
Gears: Straight Bevel
Seals: Triple Lip Spring Loaded
Bearings: Tapered, Ball, Needle
Oil Cap: 25 oz. (0.7 L)
Weight: 26 lbs. (11.8 kg)

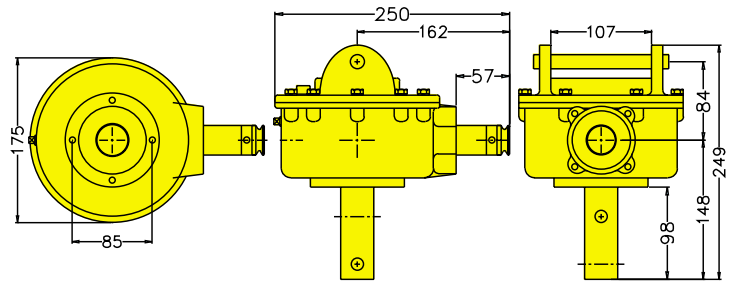

PHD-25 Series

Power: 44 hp
33 kW

Specifications

Torque: 5133 lb.-in.
580 Nm.
Ratios: 2.92:1
Gears: Straight Bevel
Seals: Triple Lip Spring Loaded
Bearings: Tapered, Ball, Needle
Oil Cap: 37 oz. (1.1 L)
Weight: 43 lbs. (19.5 kg)

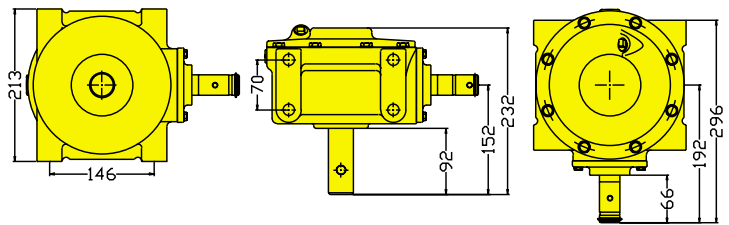

PHD-26 Series

Power: 44 hp
33 kW

Specifications

Torque: 5133 lb.-in.
580 Nm.
Ratios: 2.92:1
Gears: Straight Bevel
Seals: Triple Lip Spring Loaded
Bearings: Tapered, Ball, Needle
Oil Cap: 38 oz. (1.1 L)
Weight: 48 lbs. (21.8 kg)

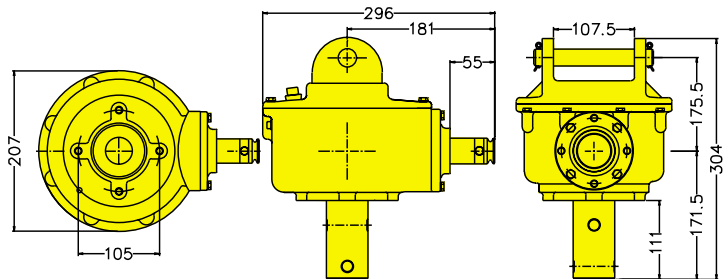

PHD-50 Series

Power: 57 hp
43 kW

Specifications

Torque: 6650 lb.-in.
751 Nm.
Ratios: 3.18:1
Gears: Straight Bevel
Seals: Triple Lip Spring Loaded
Bearings: Tapered, Ball, Needle
Oil Cap: 57 oz. (1.7 L)
Weight: 60 lbs. (27.2 kg)

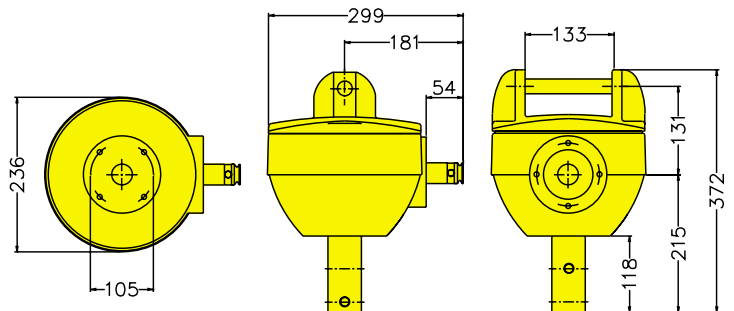

Ratios: Other ratios available on request

Power: Hp & Torque based on AGMA formula for continuous duty plus a service or load class factor.

Shafting: Various dimensional, metallurgical, and heat-treat options available.

Bearings: Geardrives available with various bearing life options.

Lubrication: Drives available with various lubes depending on operating characteristics.

PHD-75 Series

Power: 88 hp
66 kW

Post Hole Digger Drives

Specifications

Torque: 10,267 lb.-in.
1159 Nm.
Ratios: 4:1
Gears: Straight Bevel
Seals: Triple Lip Spring Loaded
Bearings: Tapered Roller
Oil Cap: 138 oz. (4.1 L)
Weight: 110 lbs. (49.9 kg)

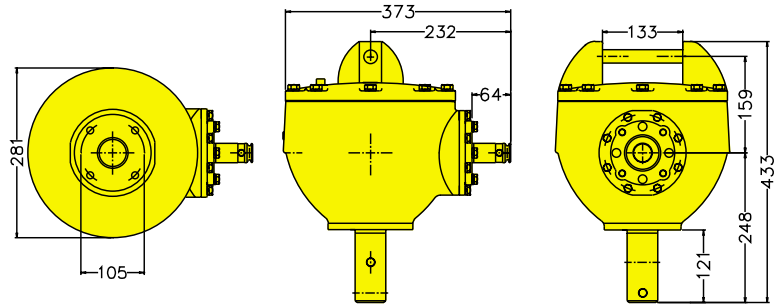

FSD-10 Series

Power: 12 hp
9 kW

Fertilizer Spreader Drives

Specifications

Torque: 1400 lb.-in.
158 Nm.
Ratios: 1:1
Gears: Straight Bevel
Seals: Triple Lip Spring Loaded
Bearings: Deep Groove Ball
Oil Cap: 8 oz. (0.2 L)
Weight: 14 lbs. (6.4 kg)

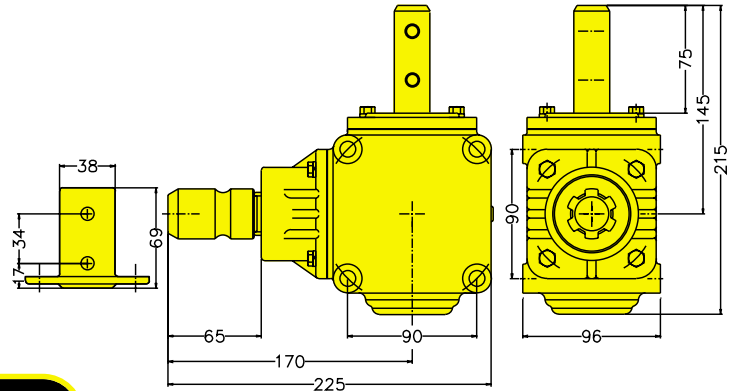

FSD-15 Series

Power: 50 hp
37 kW

Specifications

Torque: 5833 lb.-in.
659 Nm.
Seals: Triple Lip Spring Loaded
Bearings: Deep Groove Ball
Oil Cap: 8 oz. (0.2 L)
Weight: 110 lbs. (49.9 kg)

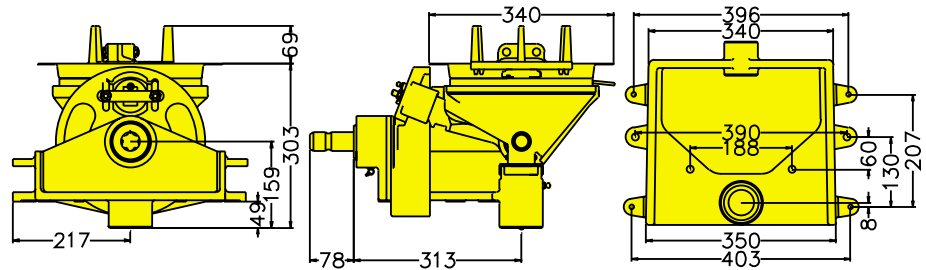

FSD-20 Series

Power: 32 hp
24 kW

Specifications

Torque: 3733 lb.-in.
421 Nm.
Ratios: 1:1.06
Gears: Straight Bevel
Seals: Triple Lip Spring Loaded
Bearings: Deep Groove Ball
Oil Cap: 16 oz. (0.5 L)
Weight: 44 lbs. (20.0 kg)

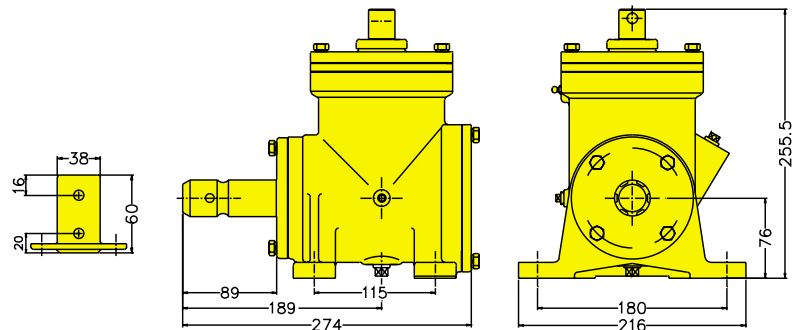

Ratios: Other ratios available on request

Power: Hp & Torque based on AGMA formula for continuous duty plus a service or load class factor.

Shafting: Various dimensional, metallurgical, and heat-treat options available.

Bearings: Geardrives available with various bearing life options.

Lubrication: Drives available with various lubes depending on operating characteristics.

FSD-40 Series

Power: 24 hp
18 kW

Fertilizer Spreader Drives

Specifications

Torque: 2800 lb.-in.
316 Nm.

Ratios: 3:1, 1.65:1

Gears: Straight Bevel

Seals: Triple Lip Spring Loaded

Bearings: Deep Groove Ball

Oil Cap: 45 oz. (1.3 L)

Weight: 82 lbs. (37.2 kg)

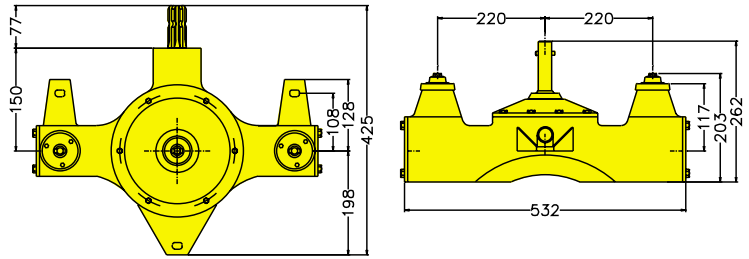

RTD-10 Series

Power: 15 - 38 hp
11 - 28 kW

Rotary Tiller Drives

Specifications

Torque: 1,750 - 4,433 lb.-in.
198 - 501 Nm.

Ratios: 1.92:1, 1.46:1, 1:1

Gears: Straight Bevel

Seals: Triple Lip Spring Loaded

Bearings: Tapered Roller / Deep Groove Ball

Oil Cap: 26 oz. (0.8 L)

Weight: 35 lbs. (15.9 kg)

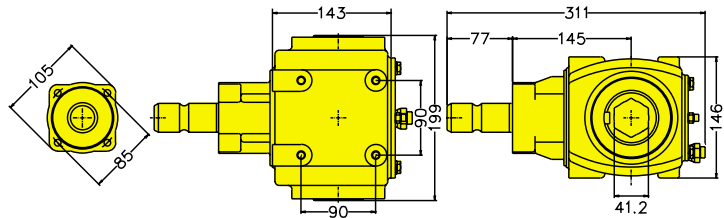

RTD-15 Series

Power: 18 - 50 hp
13 - 37 kW

Specifications

Torque: 2,100 - 5,833 lb.-in.
237 - 659 Nm.

Ratios: 1.92:1, 1.46:1, 1:1

Gears: Straight Bevel

Seals: Triple Lip Spring Loaded

Bearings: Tapered Roller / Deep Groove Ball

Oil Cap: 38 oz. (1.1 L)

Weight: 41 lbs. (18.6 kg)

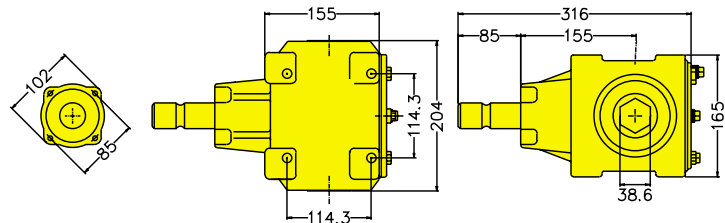

RTD-20 Series

Power: 38 - 71 hp
28 - 53 kW

Specifications

Torque: 4,433 - 8,283 lb.-in.
501 - 935 Nm.

Ratios: 1.87:1, 1.47:1, 1:1

Gears: Straight Bevel

Seals: Triple Lip Spring Loaded

Bearings: Tapered Roller / Deep Groove Ball

Oil Cap: 46 oz. (1.4 L)

Weight: 55 lbs. (25.0 kg)

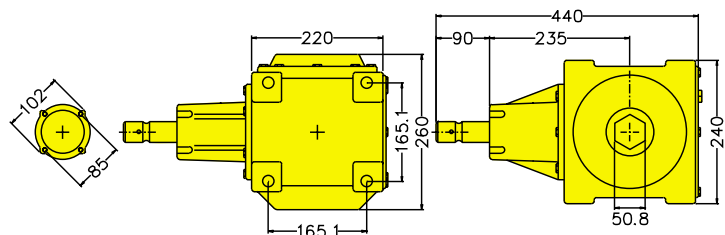

Ratios: Other ratios available on request

Power: Hp & Torque based on AGMA formula for continuous duty plus a service or load class factor.

Shafting: Various dimensional, metallurgical, and heat-treat options available.

Bearings: Geardrives available with various bearing life options.

Lubrication: Drives available with various lubes depending on operating characteristics.

RTD-30 Series

Power: 15 - 34 hp
11 - 25 kW

Rotary Tiller Drives

Specifications

Torque: 1,750 - 3,967 lb.-in.
198 - 448 Nm.
Ratios: 1.85:1, 1.46:1
Gears: Straight Bevel
Seals: Triple Lip Spring Loaded
Bearings: Tapered Roller / Deep Groove Ball
Oil Cap: 48 oz. (1.4 L)
Weight: 62-84lbs. (28-38 kg)
Length: X = 400 - 900mm

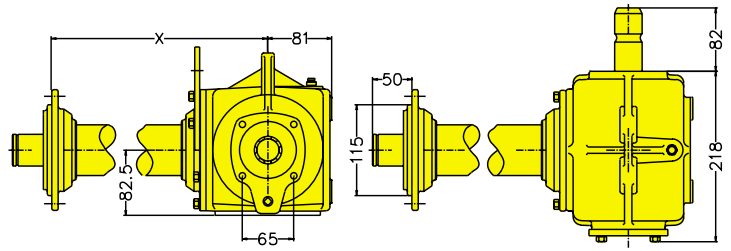

RTD-40 Series

Power: 33 - 57 hp
25 - 43 kW

Specifications

Torque: 3,850 - 6,650 lb.-in.
435 - 751 Nm.
Ratios: 1.92:1, 1.46:1
Gears: Straight Bevel
Seals: Triple Lip Spring Loaded
Bearings: Tapered Roller / Deep Groove Ball
Oil Cap: 50 oz. (1.5 L)
Weight: 92-106 lbs. (42-48 kg)
Length: X = 600 - 900mm

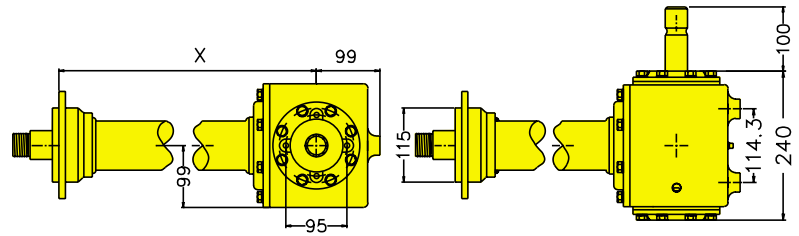

RTD-50 Series

Power: 57 - 83 hp
43 - 62 kW

Specifications

Torque: 6,650 - 9,683 lb.-in.
751 - 1,093 Nm.
Ratios: 1.86:1, 1.47:1
Gears: Straight Bevel
Seals: Triple Lip Spring Loaded
Bearings: Tapered Roller / Deep Groove Ball
Oil Cap: 82 oz. (2.4 L)
Weight: 117-131 lbs. (53-60 kg)
Length: X = 700 - 1,000mm

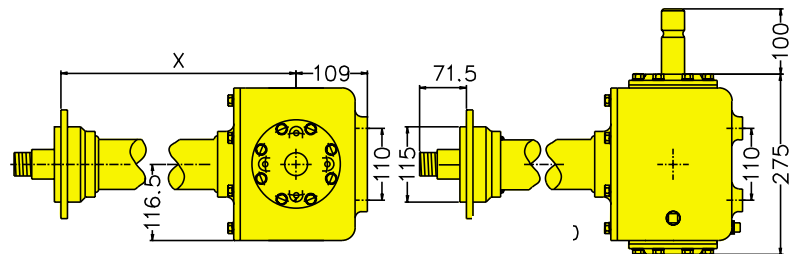

RTS-50 Series

Power: 39 - 76 hp
29 - 57 kW

Specifications

Torque: 6,557 - 8,867 lb.-in.
740 - 1,001 Nm.
Ratios: 1.75:1
Gears: Spur
Seals: Triple Lip Spring Loaded
Bearings: Tapered Roller / Deep Groove Ball
Oil Cap: 63 oz. (1.9 L)
Weight: 96 lbs. (43.6 kg)

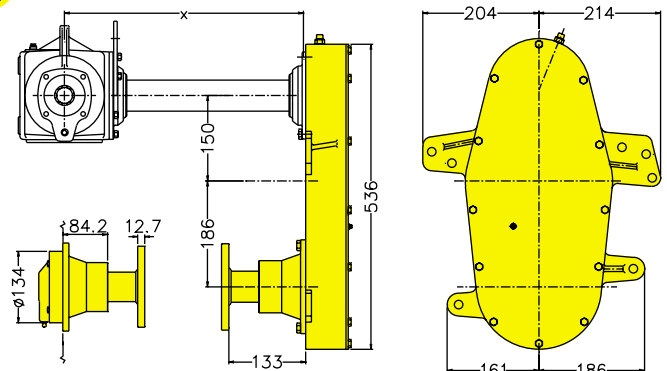

Ratios: Other ratios available on request

Power: Hp & Torque based on AGMA formula for continuous duty plus a service or load class factor.

Shafting: Various dimensional, metallurgical, and heat-treat options available.

Bearings: Geardrives available with various bearing life options.

Lubrication: Drives available with various lubes depending on operating characteristics.

OS-20 Series

Power: 48 hp
36 kW

Orchard Sprayer Drives

Specifications

Torque: 5600 lb.-in.
632 Nm.
Ratios: 1:5.0, 1:5.5
Gears: Helical
Seals: Double Lip Spring Loaded
Bearings: Deep Groove Ball
Oil Cap: 58 oz. (1.7 L)
Weight: 70 lbs. (31.8 kg)

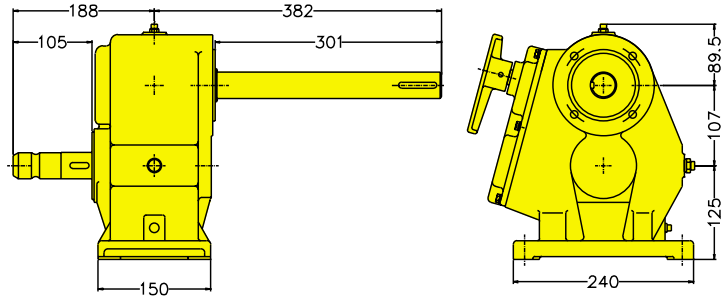

OS-40 Series

Power: 73 hp
54 kW

Specifications

Torque: 8517 lb.-in.
962 Nm.
Ratios: 1:4.0, 1:4.4
Gears: Helical
Seals: Double Lip Spring Loaded
Bearings: Deep Groove Ball
Oil Cap: 101 oz. (3.0 L)
Weight: 114 lbs. (51.8 kg)

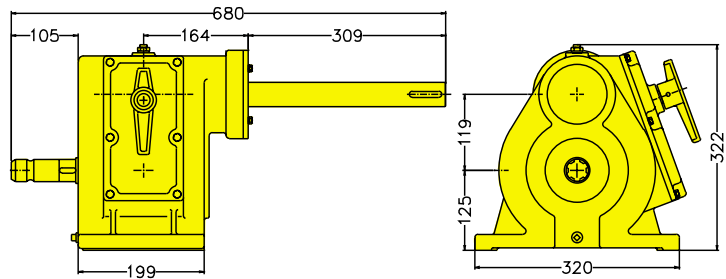

HDY-20 Series

Power: 35 - 75 hp
26 - 56 kW

Pump Drives

Specifications

Torque: 4,083 - 8,750 lb.-in.
461 - 988 Nm.
Ratios: 1:2.18, 1:3.75
Gears: Helical
Seals: Double Lip Spring Loaded
Bearings: Deep Groove Ball
Oil Cap: 15 oz. (0.4 L)
Weight: 34 lbs. (15.4 kg)

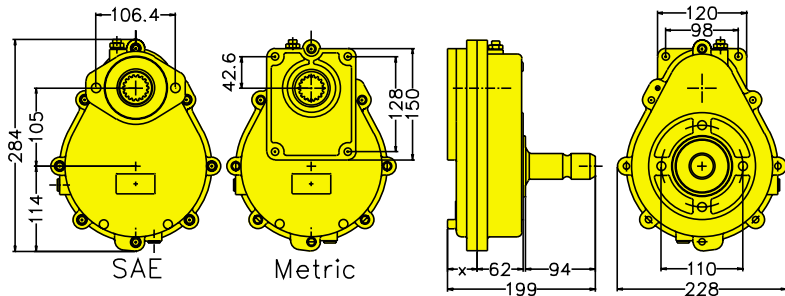

HDY-41 Series

Power: 68 - 94 hp
50 - 70 kW

Specifications

Torque: 7,875 - 10,967 lb.-in.
889 - 1,238 Nm.
Ratios: 1:2, 1:3.29, 1:4
Flanges: SAE 'B', 2 or 4 Bolt
SAE 'C', 2 or 4 Bolt
Gears: Helical
Seals: Double Lip Spring Loaded
Bearings: Tapered Roller
Oil Cap: 28 oz. (0.8 L)
Weight: 74 lbs. (33.6 kg)

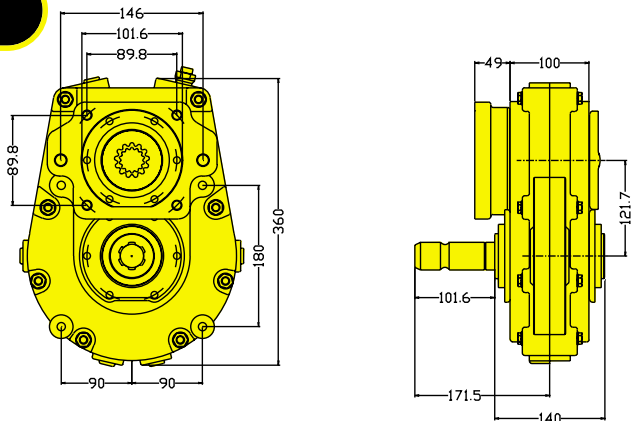

Ratios: Other ratios available on request
Power: Hp & Torque based on AGMA formula for continuous duty plus a service or load class factor.
Shafting: Various dimensional, metallurgical, and heat-treat options available.
Bearings: Geardrives available with various bearing life options.
Lubrication: Drives available with various lubes depending on operating characteristics.

HT-50 Series

Power: 15 hp
11 kW

Hay Tedder / Rake Drives

Specifications

Torque:	1750 lb.-in. 198 Nm.
Ratios:	7.2:1
Gears:	Straight Bevel
Seals:	Double Lip Spring Loaded
Bearings:	Deep Groove Ball
Oil Cap:	194 oz. (5.7 L)
Weight:	220 lbs. (99.9 kg)

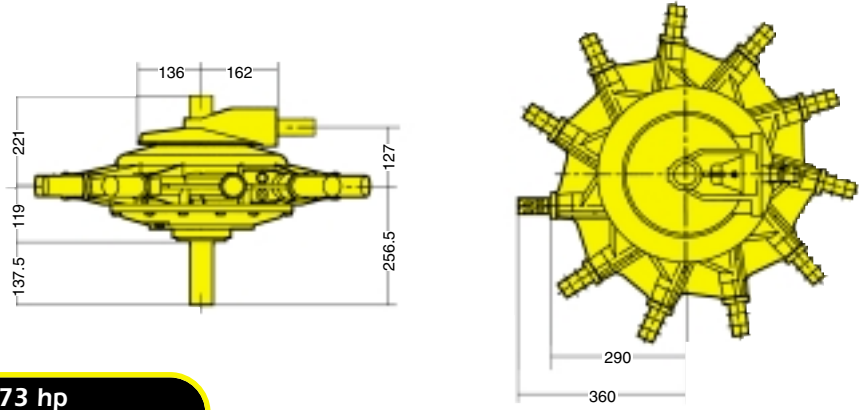

HT-75 Series

Power: 73 hp
54 kW

Specifications

Torque:	8517 lb.-in. 962 Nm.
Ratios:	3.06:1
Gears:	Straight Bevel
Seals:	Double Lip Spring Loaded
Bearings:	Deep Groove Ball
Oil Cap:	26 oz. (0.8 L)
Weight:	210 lbs. (95.3 kg)

Standard

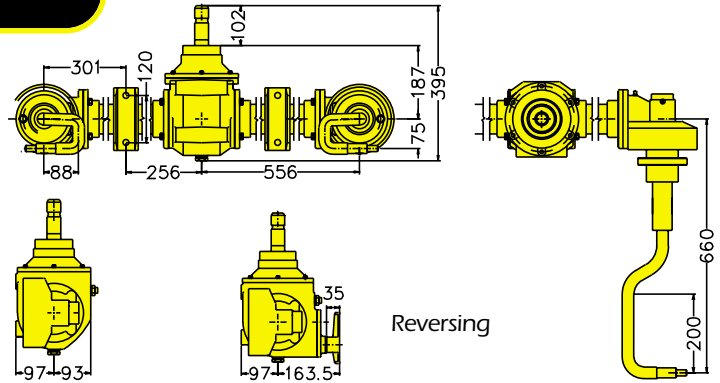

Reversing

GB-50

Power: 62 hp
46 kW

Grain Cart Drives

Specifications

Torque:	7233 lb.-in. 817 Nm.
Ratios:	1.61:1, 1.47:1, 1:1.47, 1:1.61
Gears:	Straight Bevel
Seals:	Triple Lip Spring Loaded
Bearings:	Tapered Roller
Oil Cap:	30 oz. (0.9 L)
Weight:	68 lbs. (30.9 kg)

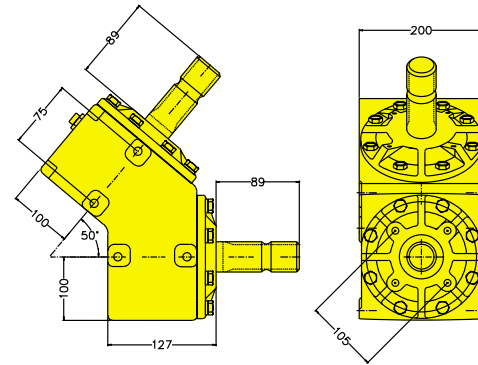

268 Series

Power: 24 hp ; 125 hp
18 kW ; 93 kW

Grain Auger Drives

Specifications

Torque:	2800 lb.-in. ; 14,583lb.-in. 316 Nm. ; 1646 Nm.
Ratios:	1:1
Gears:	Straight Bevel
Seals:	Triple Lip Spring Loaded
Bearings:	Tapered Roller
Oil Cap:	15 oz. (0.4 L)
Weight:	25 lbs. (11.4 kg)

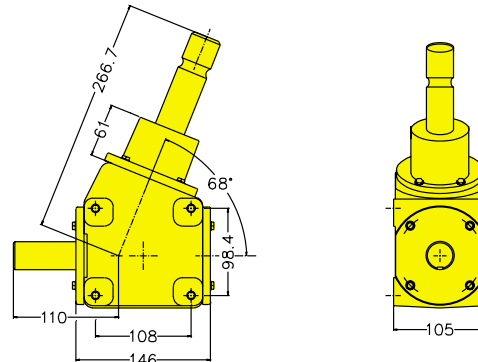

Ratios: Other ratios available on request

Power: Hp & Torque based on AGMA formula for continuous duty plus a service or load class factor.

Shafting: Various dimensional, metallurgical, and heat-treat options available.

Bearings: Geardrives available with various bearing life options.

Lubrication: Drives available with various lubes depending on operating characteristics.

Shaft Options

Various dimensional, metallurgical and heat treat options available.

Shaft Chart

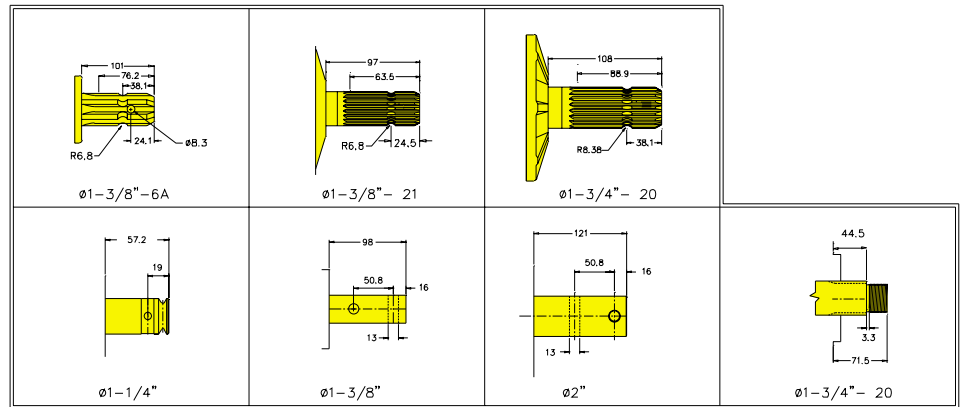

Configuration Options

Configuration Chart

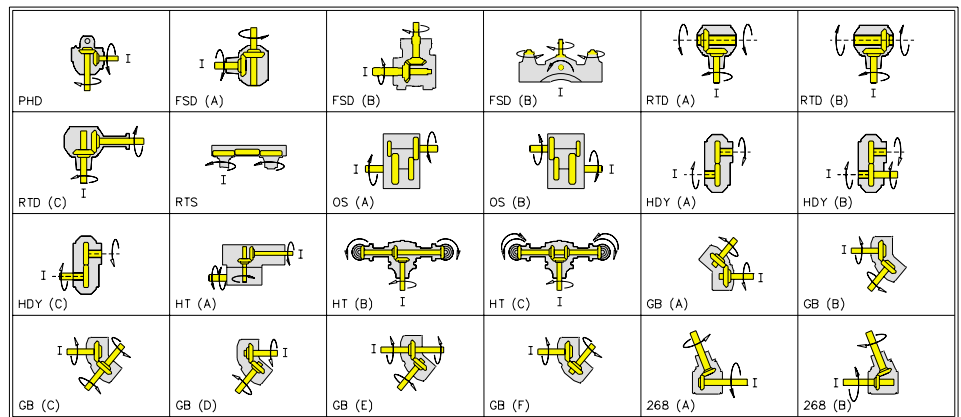

Warranty

Omni Gear's Enclosed Geardrives are warranted to be free of defects in material or workmanship and to meet Omni Gear's specifications at the time of sale. For a copy of our warranty please contact Omni Gear.

Product Information

The data presented in this catalog is for general information and preliminary layout purposes only. Omni Gear, through its policy of continuous improvement, reserves the right to change specifications without notice. For specific application and dimensional information, please contact Omni Gear.

The horsepower and torque ranges given here are generalizations. Different conditions for various applications may result in a higher or lower power requirement. For these reasons, the ratings contained herein cannot be guaranteed for any application. Contact Omni Gear for ratings on specific applications. Prototype testing should be conducted for each application before production.



7502 Mesa Road □ **Houston, Texas 77028**
Phone: 713-635-6331 □ **Fax: 713-635-6360**
E-mail: Sales@OmniGear.com □ **Web: www.OmniGear.com**